



Crockford Park Road, Addlestone, KT15 2LQ





Offered to the market with no onward chain is this well presented Two Bedroom Second Floor Apartment in a popular retirement development. Situated a short walk from the town centre and in pretty, well kept communal gardens, the apartment is located close to the lift and comprises a good sized living room, L shaped kitchen, main bedroom with en-suite shower room and second bedroom which, like the main bedroom has built in wardrobes. The development benefits from a residents lounge, on site manager, attractive communal gardens, laundry room and guest suite for visitors. It is a condition of purchase that residents be over the age of 60 years.



Leasehold

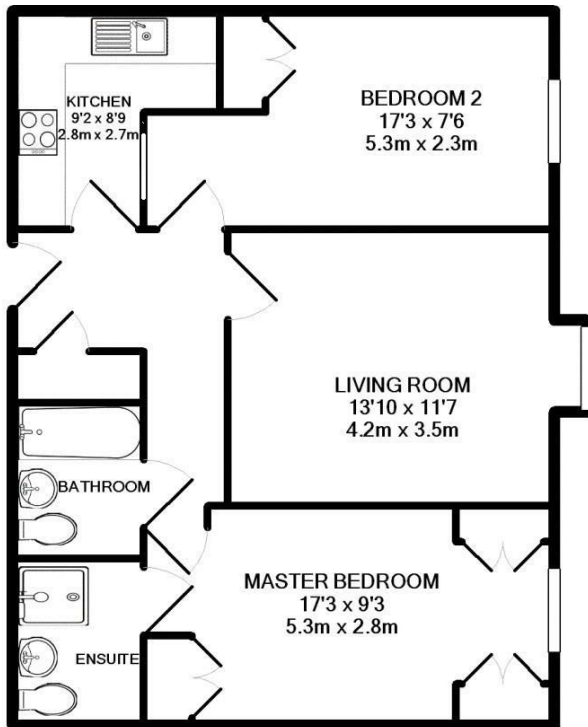

TOTAL APPROX. FLOOR AREA 690 SQ.FT. (64.1 SQ.M.)

Whilst every attempt has been made to ensure the accuracy of the floor plan contained here, measurements of doors, windows, rooms and any other items are approximate and no responsibility is taken for any error, omission, or mis-statement. This plan is for illustrative purposes only and should be used as such by any prospective purchaser. The services, systems and appliances shown have not been tested and no guarantee as to their operability or efficiency can be given

EPC Rating: null





Grants Homes 60 Church Street, Weybridge, Surrey, KT13 8DL  
T: 01932 858885 E: [addestone@grantshomes.co.uk](mailto:addestone@grantshomes.co.uk)

